

Features

- 23.8" Full HD PCAP Multi-touch
- 7th Generation Intel® Kaby Lake Core i5 Processor
- LED Reading Light Bar
- Optional Barcode Scanner
- Optional Built-in Privacy Screen
- Optional 5.0M Auto-focus Camera with cover
- Optional 2 x 6900mAh Hot Swappable Batteries
- Optional 4 Slots Charging Bay
- IP65 Front Panel Protection

Specifications

| System | |
|------------------------|--|
| CPU | 7th Generation Intel® Kaby Lake Core i5-7300U Processor |
| System Chipset | Integrated in Processor (SOC) |
| System Memory | 2 x 260pin SODIMM socket up to 32GB Per Slot DDR4 2400 SDRAM |
| Wireless Communication | Optional Wi-Fi 1T1R 802.11b/g/n/ac/ BT4.0 |
| Watchdog Timer | H/W Reset, 1sec. ~ 65535sec. and 1sec./step |
| H/W Status Monitor | Monitoring System Temperature & Voltage |
| Battery | Optional Smart Battery Pack 14.4V 6900mAh, 99.4Wh |
| Expansion | 1 x M.2 E Key 2230 1 x mPCIe with SATA or PCIe x1 mSATA |
| Storage | 1 x 2.5" Drive Bay |
| OS Information | Win10 64 bit/Linux |
| Panel | |
| LCD Size | 23.8" |
| Display Type | Full HD |
| Resolution | 1920x1080 |
| Pixel Pitch | 274.5x274.5 |
| Contrast Ratio | 3000 |
| Luminance | 250 cd/m2 |
| Viewing Angle | 89(U), 89(D), 89(L), 89(R) |
| Response Time | 16ms |
| Backlight | LED |
| Touch Type | Projective Capacitive |
| Touch Controller | EETI EXC84H5680 |
| Data Collection | |
| Camera | 5.0M CMOS with Auto-focus |
| NFC | Built-in NFC RFID Module |

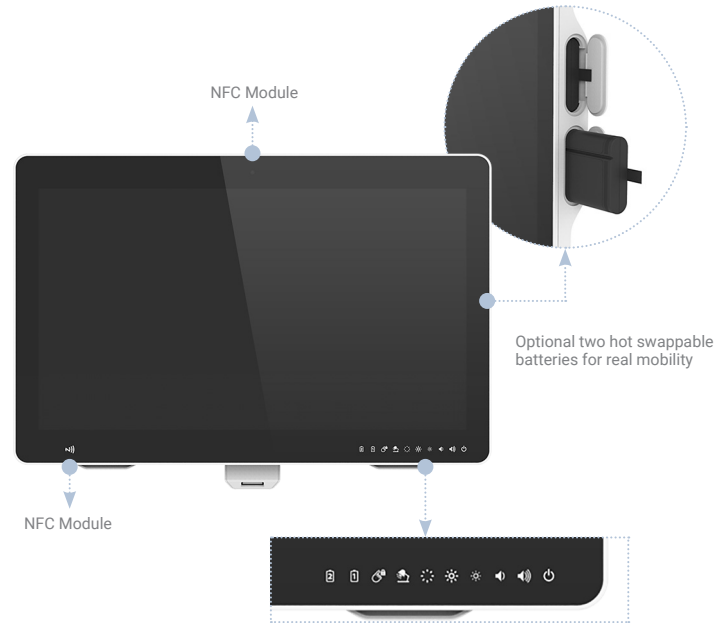

| Audio | |
|---------------------------|---|
| Chipset | Realtek ALC892 |
| Speaker Output | 2 x 2W |
| Ethernet | |
| Chipset | 1 x Intel® I211AT, 1 x Intel® I219LM |
| Interface | 10/100/1000 Base-Tx GbE compatible |
| LAN Port | 2 x RJ-45 |
| I/O | |
| USB | 4 x USB 3.0 |
| SATA | 1 x SATA III |
| HDMI | 1 x HDMI |
| Display Port | 1 x DP |
| Power Requirement | |
| Power Connector | Lockable DC Jack, +12V~+24V |
| Power Mode | AT/ATX (ATX is default setting) |
| Adapter | Medical grade 120W/24V |
| Certification Information | |
| CE | IEC/EN60601-1-2 |
| FCC | Part 15 Class B |
| UL60601-1 | AAMI /ANSI ES60601-1:2005/(R)2012 and A1:2012,C1:2009/(R)2012 and A2:2010/(R)2012 |
| CB | IEC 60601-1/A1:2012 & EN 60601-1/A1:2013 (Ed 3.1) EN 60601-1:2006+A11:2011+A1:2013+A12:2014 |

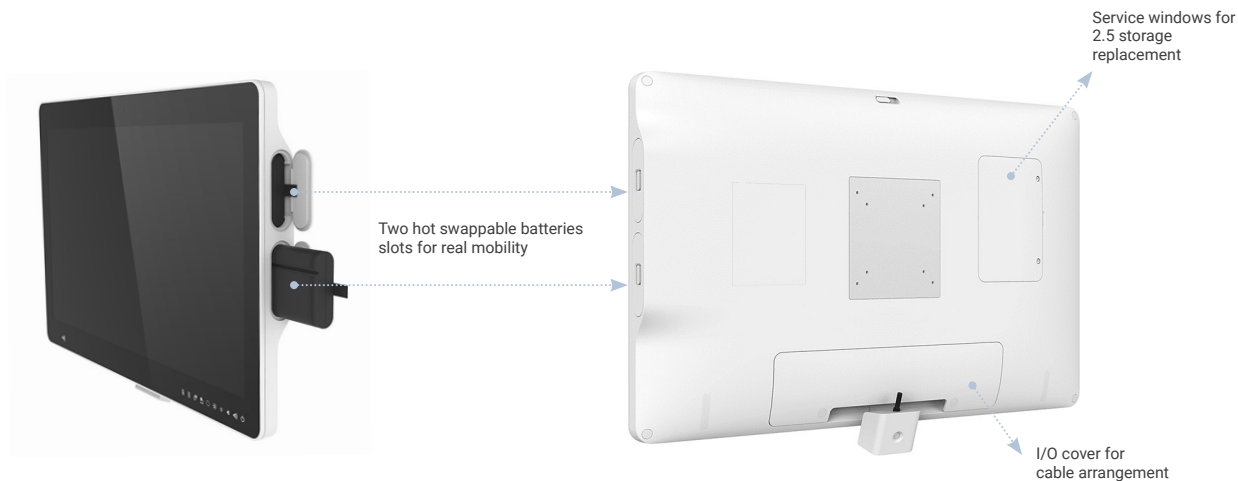

Mechanical and Environment

| | |
|-----------------------------|---|
| Power Type | DC in +19V~24V |
| Operating Temp | 0°C ~ 40°C (32°F ~ 104°F) |
| Storage Temp | -30°C ~ 70°C (-22°F ~ 158°F) |
| Operating Humidity | 0% ~ 90% Relative Humidity, Non-condensing |
| Weight | 6.9 kg (without Batteries and Adapter) |
| Mounting Kit | Optional Mounting Kit (VESA 75 x 75, 100 x 100) |
| Dimension | 23.3" x 15.04" x 1.95" (592 x 382 x 49.5mm) |
| IP Rating | Front IP65 |
| Vibration Test | With SSD/mSATA : 1.5Grms, IEC 60068-2-64, Random, 5 ~ 500Hz, 30min/axis |
| Shock Test | With CF/SSD : 10Grms, IEC 60068-2-27, Half Sine, 11ms |
| System Fan | Fanless |
| Construction - Front / Rear | White Plastic / White Plastic |
| Finishing | Anti-Microbial |
| Fanless | Yes |
| Color | White |

Mechanical and Environment

| | |
|-----------------|---------------------------------|
| Power Connector | Lockable DC Jack, +12V~+24V |
| Power Mode | AT/ATX (ATX is default setting) |
| Adapter | Medical Grade, 120W/24V |



4 Slots Battery Charger

Ordering Info

| | |
|--------------------|--|
| HID-2334-730-A1R | 23.8" Intel® Core™ i5-7300U Processor/8GB Memory/LED/NFC/4USB3.0/SPK/24V medical adapter. SSD/ Wifi/ Battery Not included. |
| ACC-HID-WIFI-02R | HID-2334 Wi-Fi Kit |
| ACC-BAT-4S2P-01R | Rechargeable Lithium Ion Battery,4S2P |
| RCC-HID-BATCHR-01R | 4 Bay Charging Station w/120W Power Adapter |

* All product specifications and images are subject to change without notice. Last update: 2020/11/30

